

MK 15-40 TURBO SUBMERSIBLE MIXERS

Submersible mixers made of stainless steel or acid-resistant steel, for operation in particularly demanding conditions. Modern design with high-performance turbine rotor.

Three types of guides can be used for installation and handling of mixers, including self-service guides equipped with their own winch.

Functions:

- mixing of wastewater
- mixing and aeration of wastewater
- homogenization
- prevention of sediment deposition
- elimination of froth and coat

Mixer symbol	MK15.8	MK18.8	MK22.8	MK25.8	MK28.8	MK30.8	MK35.8	MK40.8	Unit
Mixer power	1.5	1.8	2.2	2.5	2.8	3.0	3.5	4.0	kW
Revolutions	720	708	698	720	716	714	708	700	rpm
Rotor diameter	380 - 580								mm
Rotor type	Turbine rotor, two- or three-blade, self-cleaning								-
Seals	two-level frontal seal with oil buffer chamber								-
Mixing capacity	165	210	220	250	280	300	320	360	m ³
Mixing economy	9	9	10	10	10	10	11	11	W/m ³
Mixing range	19	22	23	26	27	28	29	30	m
Power supply	3 x 400 (50Hz)								V
Power cable	standard or screened, length 6m (longer cable available upon request)								m
Material	stainless or acid-resistant steel (exterior elements made of 304 or 316 steel)								-
Weight	48	48	48	59	59	59	59	59	kg

Additional equipment (optional)

- angle attachment for deflecting mixer by 15° or 25° from level
- rotor guard (jet orifice) increasing mixing performance
- attachment for mixing with simultaneous aeration of wastewater
- coupling flanges enabling operation as pumping mixers
- built-in water presence, moisture and motor temperature sensors

Guide types

PST-standard (under hatch), PSO-self-service, PSN-self-bearing

The data above should be given in greater detail and updated based on information on www.biox.pl

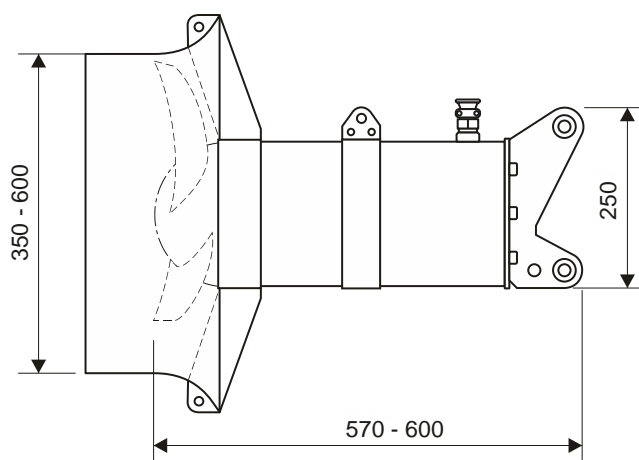

od 1989

mieszadła



natleniacze



dekantery



zbieracze



żurawiki



przewodnice



wciągarki